

THE LOW-SERIES LOW PROFILE HYDRAULIC HEXAGON TORQUE WRENCHES ARE AN ESSENTIAL TOOL FOR LIMITED CLEARANCE APPLICATIONS

The versatile LOW-Series torque wrenches support an extensive range of interchangeable hexagon ratchet cassettes that deliver a torque range of 232 to 44,593 Newton metres (169 to 32,396 ft/lbs)



LOW Hex Range
19 - 175 mm

LOW Torque Range
232 - 44,593 Nm

Max Operating Pressure
700 Bar

BOLTING SOLUTIONS

360°/ 180° SWIVEL COUPLERS

with screw couplings

ACCURACY

within + / - 3%

HIGH STRENGTH

titanium aluminium alloy body

REDUCER INSERTS

are available in metric and imperial sizes

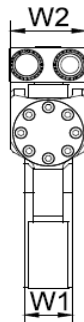
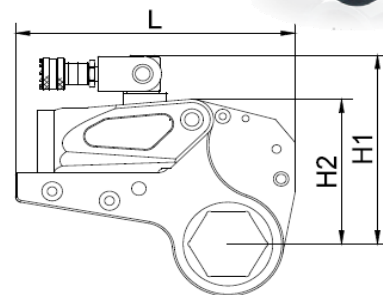

ANTI LOCKING LEVER
Ease of removing the tool

WIDE RANGE
of metric and imperial interchangeable hexagon ratchet cassettes available

REACTIONS EXTENSION / PADDLES
are available in all length and size



Model	Range of Torque (Nm) @ 700 bar	Hexagon Size Range (mm)	L (mm)	H1 (mm)	H2 (mm)	W1 (mm)	W2 (mm)	Weight Power Head (kg)	Weight Ratchet Link (kg)
2LOW	232-2,328	19-55	197	126	102	32	51	1.0	1.6
	241-2,414	60	197	129	105	32	51	1.0	1.7
4LOW	585-5,858	34-65	245	177	136	42	66	2.0	4.4
	647-6,474	70-80	246	187	146	42	66	2.0	4.6
8LOW	1,094-10,941	41-95	300	207	169	53	83	3.3	8.0
	1,177-11,774	100-105	301	216	178	53	83	3.3	8.4
14LOW	1,852-18,521	50-117	361	239	204	64	99	5.5	11.6
30LOW	4,188-41,882	85-155	430	303	272	85	131	11.4	29.0
	4,459-44,593	160-175	441	315	285	85	131	11.4	30.0